

7. Schematic Diagram

7-1. MT8226 & EMMA Block Diagram

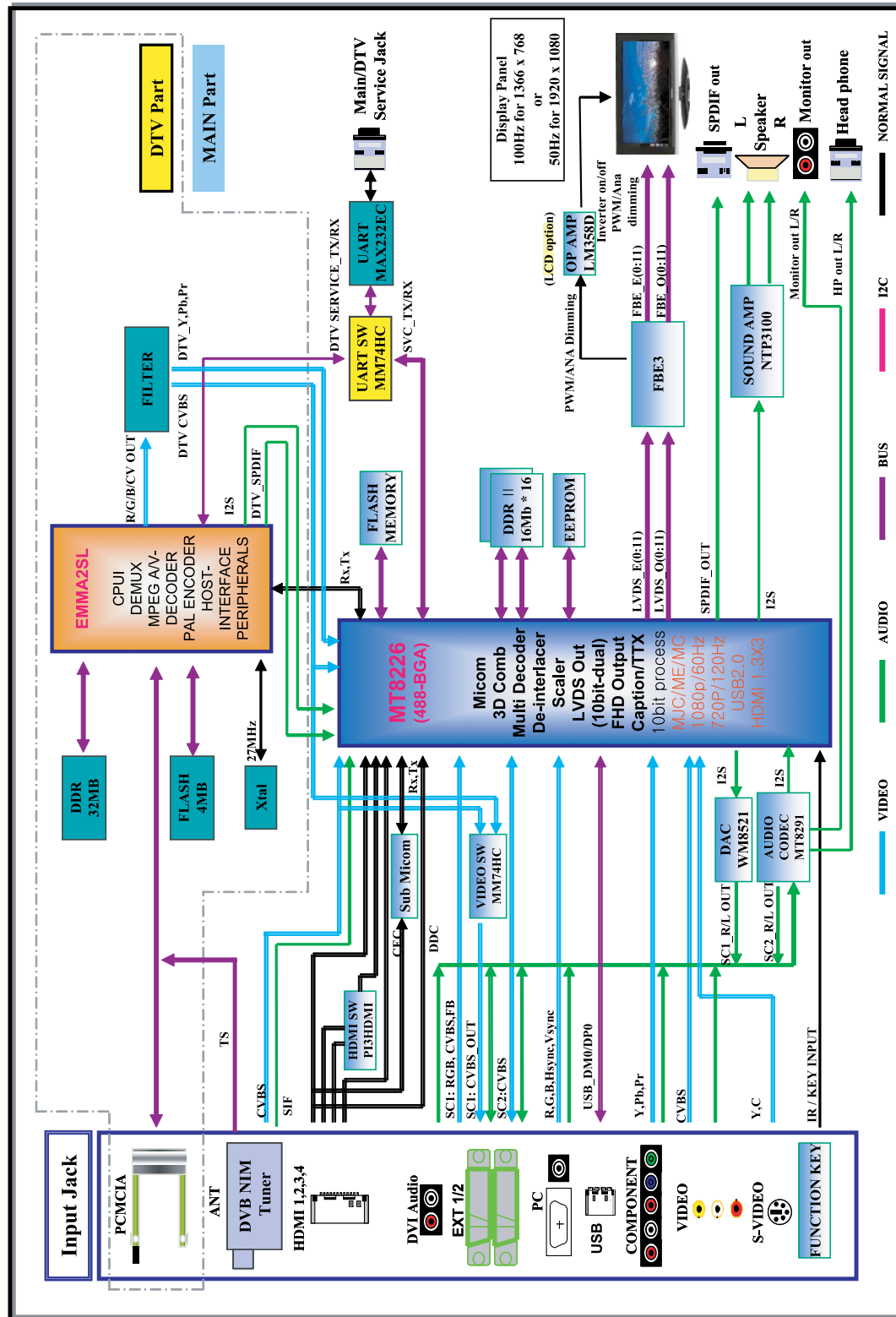

The Block Processing Video Signal
<ol style="list-style-type: none">1. Component, PC and CVBS signal like AV are inputted to Scaler-IC (MT8226(IC5105)) directly.2. HDMI signal is inputted to switch-IC, TMDS351 to select just 1-HDMI input in 3-HDMI input. (But HDMI3 (Side) inputted to Scaler-IC directly), And then Selected HDMI signal is inputted to Scaler-IC.3. Scaler-IC converts video signal to 12bit of LVDS Signal, standard format to run a LCD panel.4. FBE3-IC receives this LVDS signals and processing it to enhance picture quality. And then final 12bit of LVDS Signal is outputted.

The Block Processing Sound Signal
<ol style="list-style-type: none">1. Sound signals of RF(SIF), HDMI, Component, DVI, PC and AV input are inputted to Sound-IC (MT8291 (IC2102)). DTV_AUDIO signal is also inputted for MP3 connected to wiselink. MT8291(IC2102) processes these signal and outputs 12C signal to digital AMP-IC (NTP3100 (IC2104)). And signals for headphone and Monitor-out are outputted.2. NTP-3100 IC outputs an analog sound signal to run Speakers.

7-3. Schematic Diagrams

7-3-1. MAIN POWER BLOCK

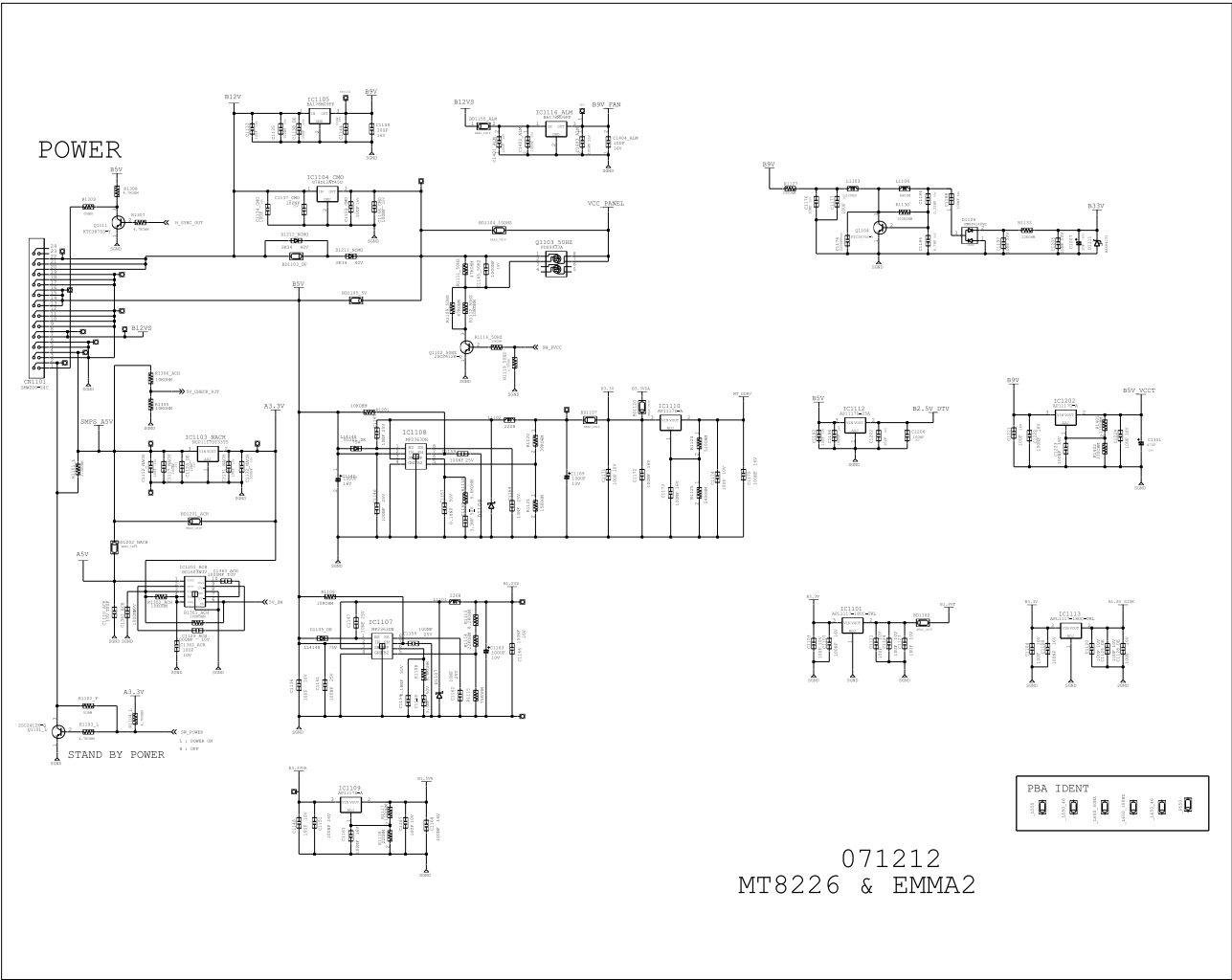



7-3-4. Jack_In_Out-2 & HDMI_Switch

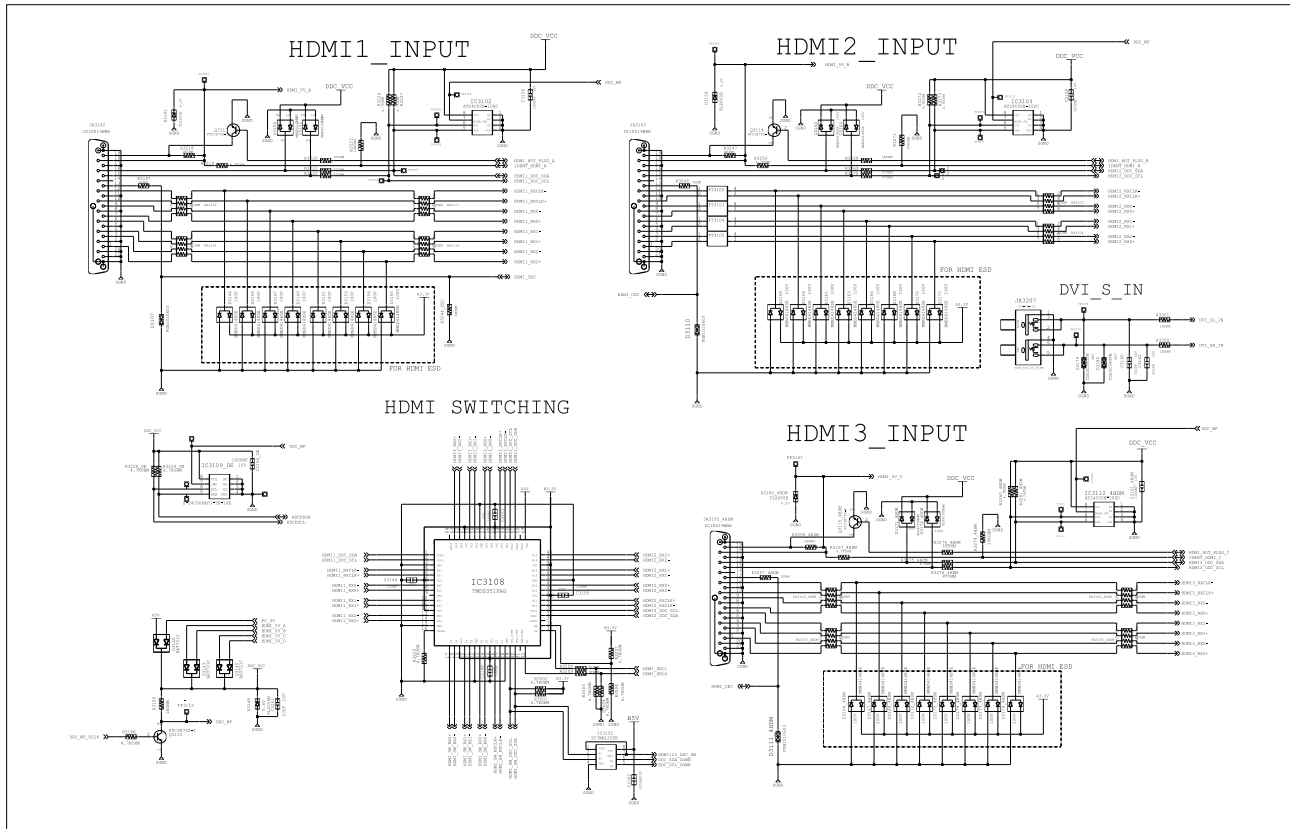

7-3-5. Jack_In_Out-3 & Tuner

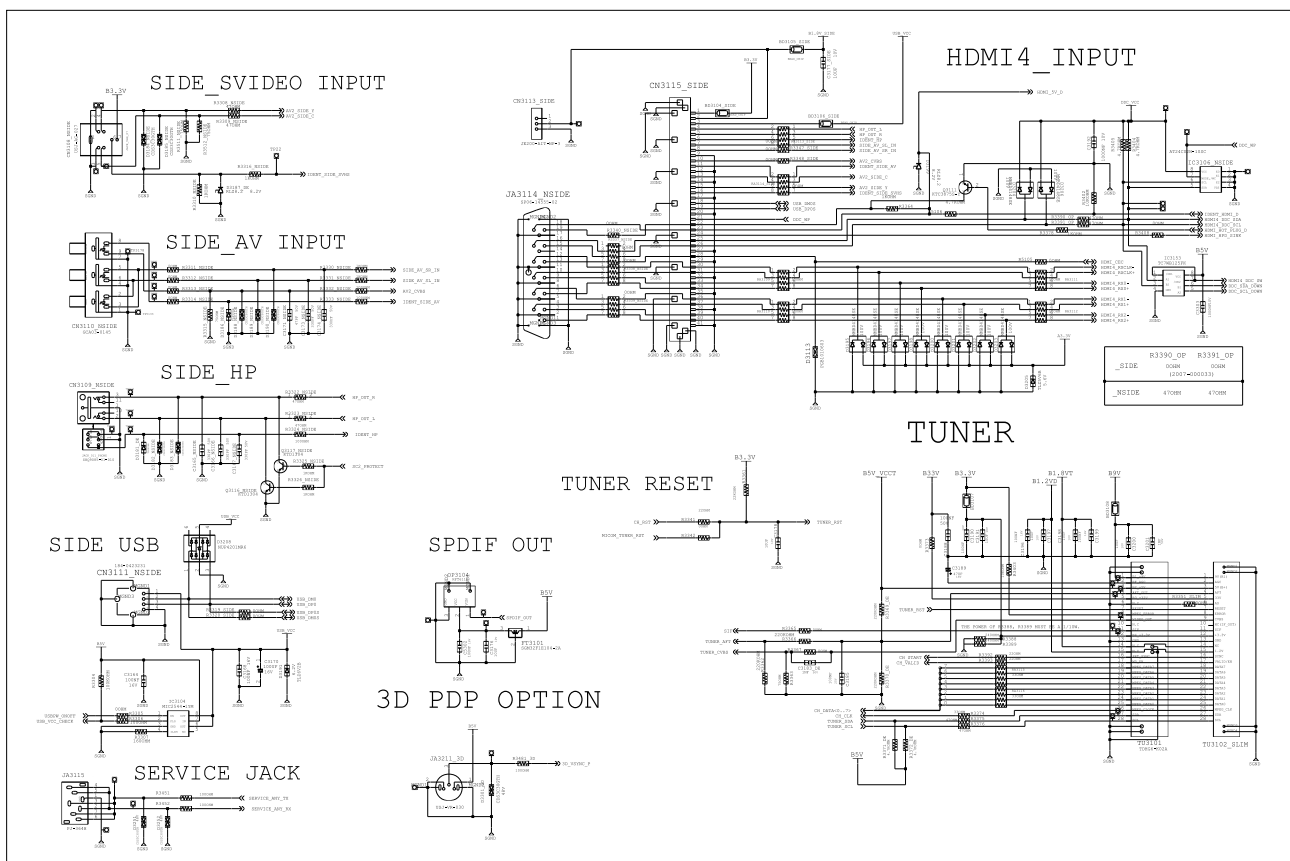

7-3-6. Scaler-1 & Flash memory & Sub-Micom

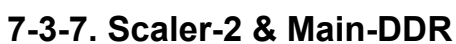

7-3-8. Scaler-Power & Service

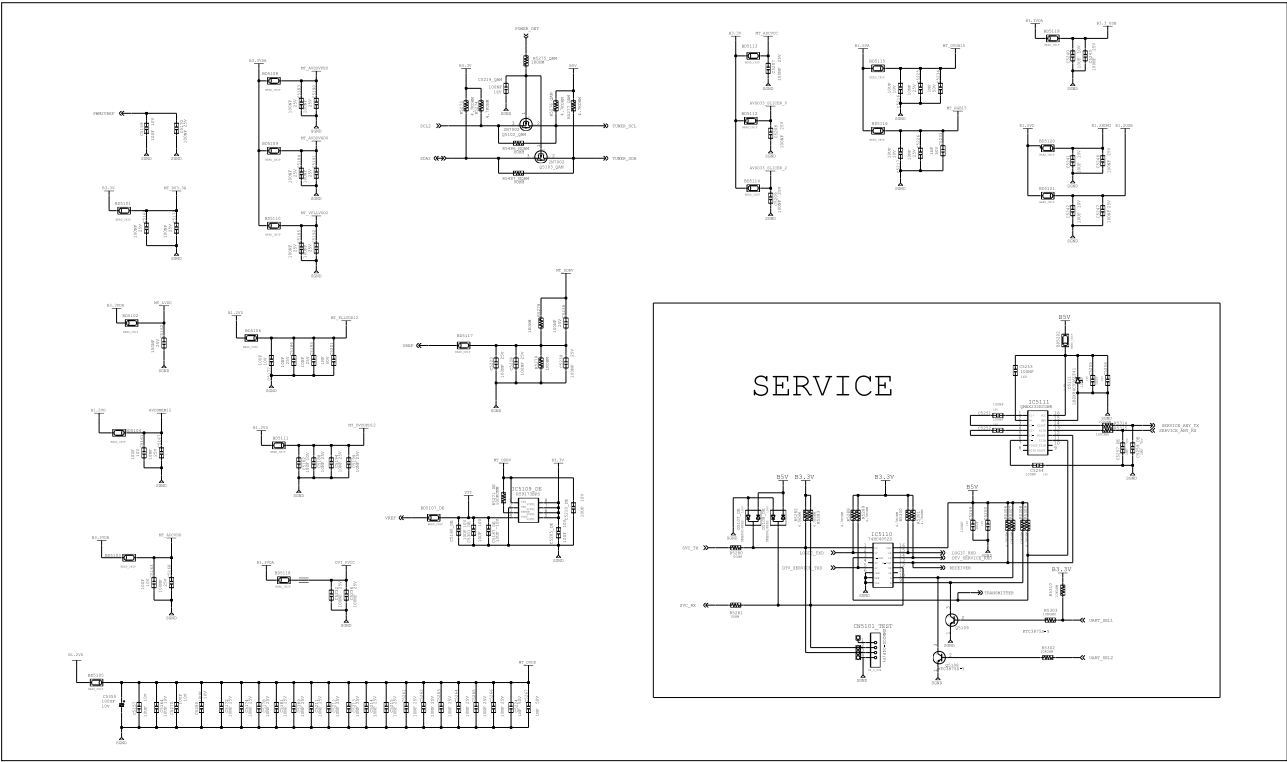

7-3-9. FBE3 & LVDS Out

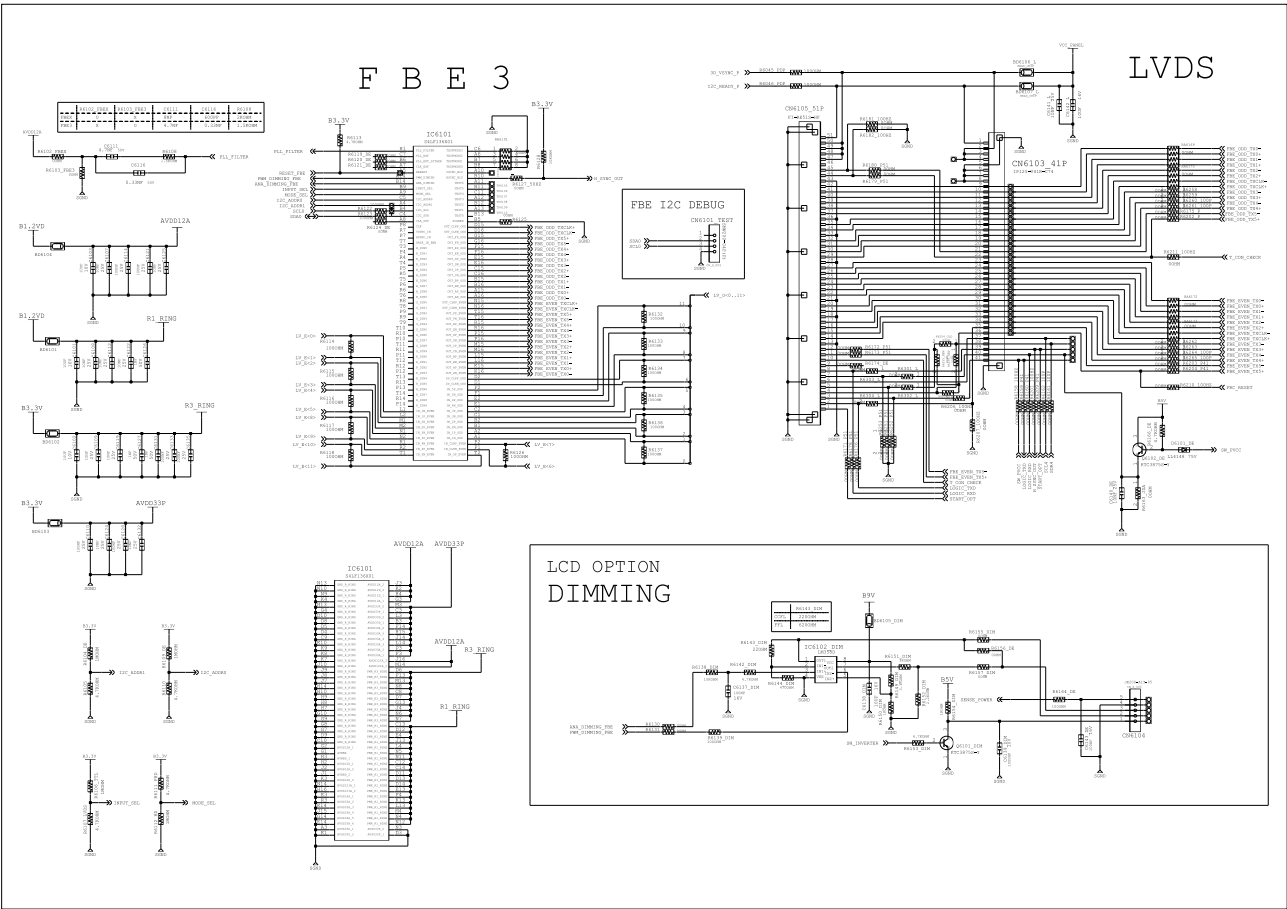

7-3-10. Emma2 & DTV-DDR

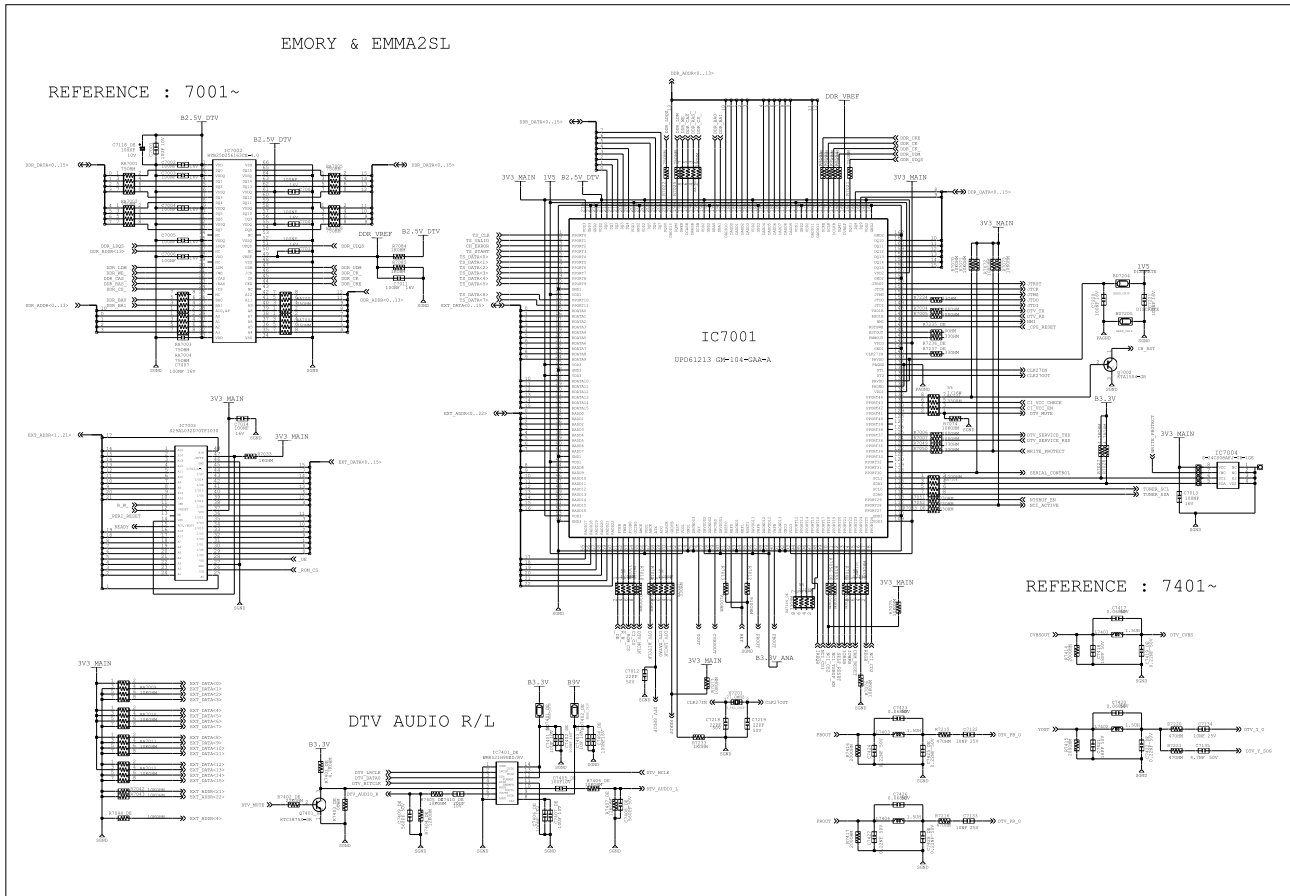

7-3-11. Emma2SL & PCMCIA & Flash memory

